



THANK YOU FOR YOUR PURCHASE!

FOR ANY QUESTIONS PLEASE REACH OUT TO:

info@cfmotousaparts.com

(845) 5-CFMOTO

(845) 523-6686

9AM-5PM EST Mon-Fri

OUR FRIENDLY STAFF IS READY TO ASSIST YOU

ACCESSORY SETUP INSTRUCTION

SKID PLATE ASSEMBLY, 1-UP -- PN 9DQV-804100-3000

VALID FOR: MY22 and Newer G2 CFORCE 400 & 500

BEFORE YOU BEGIN: Read and understand the instructions before starting any work. Make sure that all parts are ready and that you have all the tools required for assembly.

NOTE: CFMOTO shall not be liable for any damage caused by incorrect assembly. CFMOTO recommends that all original accessories be assembled by an authorized CFMOTO dealer.

Before assembly, park the vehicle on a flat surface, put the transmission gear into Park (P) and turn off the key switch.

Zhejiang CFMOTO Power Co., Ltd. All rights reserved. Reproduction of this document, even in part, as well as copying of all kinds, is permitted only with the express written permission of the copyright owner.

MEANING OF SYMBOLS



- Indicates information with more details or tips.



- Indicates information of warning or danger.

PARTS LIST:

ITEM	PART NAME	PART NUMBER	QTY.	REMARK
1	SKID PLATE ASSY, SHORT	9DQV-804100-3000	1	Picture is for structure reference only.
2	FRONT SKID PLATE	9DQV-804101-3000	1	
3	MIDDLE SKID PLATE	9DQV-804102-3000	1	
4	REAR SKID PLATE	9DQV-804103-3000	1	
5	LH SKID PLATE	9DQV-804104-3000	1	
6	RH SKID PLATE	9DQV-804105-3000	1	
7	PANEL, LH FRONT SWING ARM	9DQV-804106-3000	1	
8	PANEL, RH FRONT SWING ARM	9DQV-804107-3000	1	
9	PANEL, LH REAR SWING ARM	9DQV-804108-3000	1	
10	PANEL, RH REAR SWING ARM	9DQV-804109-3000	1	
11	BOLT M10×40	30006-102040860	2	
12	BOLT M6×40	30006-060040870	16	
13	BOLT M6×20	30006-060020870	22	
14	SELF-LOCK NUT	9DQV-804100-3000-26	14	
15	RETAINER	9AWV-804106-2000	40	
16	CONNECTING BRACKET	5BWV-804110-5000	8	
17	SPACER 30×22	9DQV-804114-3000	4	
18	SPACER 30×20	9DQV-804112-3000	2	
19	SPACER 30×16	9DQV-804113-3000	2	
20	SPACER 30×8	9DQV-804115-3000	2	
21	U-SHAPE BOLT	9DQV-804100-3000-22	4	
22	WASHER 16	9DQV-804100-3000-25	10	
23	WASHER 24	9DQV-804100-3000-24	2	
24	WASHER, SWING ARM	9DQV-804100-3000-23	4	

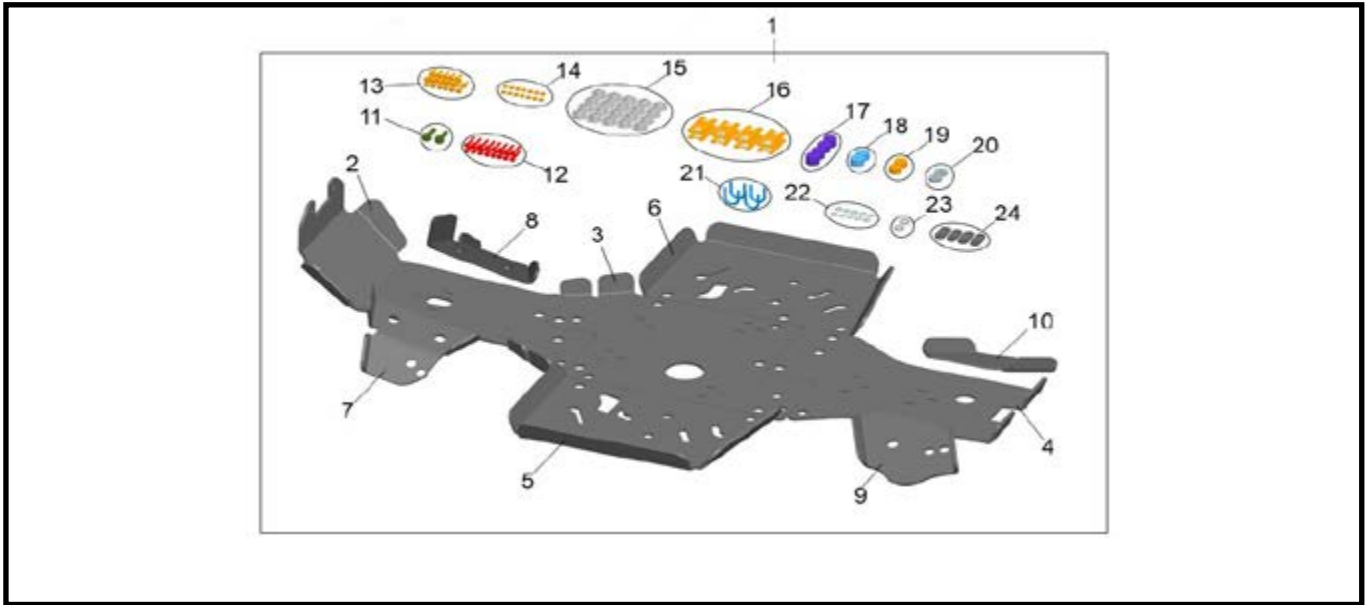

TOOL LIST:

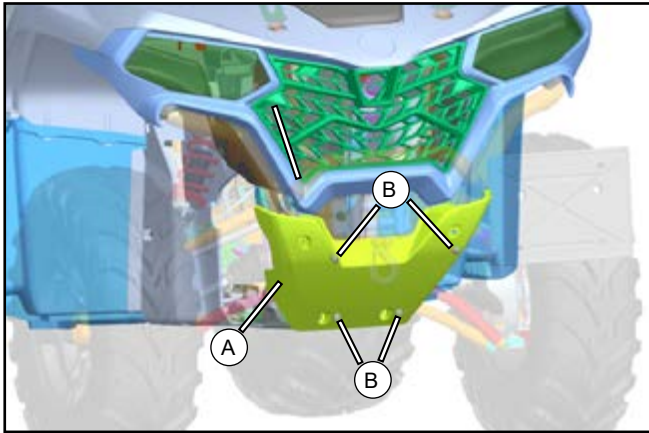
ITEM	DESCRIPTION	QTY.	REMARK
1	PROTECTIVE GLOVES	1	Recommended tools.
2	ELECTRIC WRENCH	1	
3	5mm ALLEN WRENCH	1	
4	CHARGE DRILL	1	
5	8mm SOCKET	1	
6	10mm SOCKET	1	
7	15mm SOCKET	1	
8	10mm OPEN END WRENCH	1	

ASSEMBLY and INSTALLATION

// Unscrew the bolts (B), and remove the guard (A).

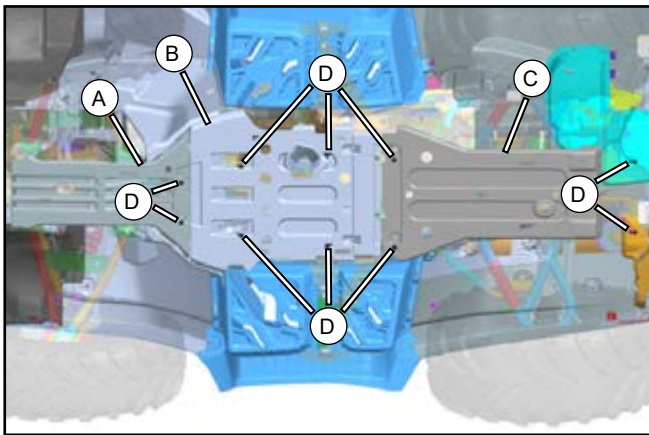
i The guard will not be reused.



// Unscrew the bolts (D), and remove the original skid plates (A,B,C).

i The skid plates will not be reused.

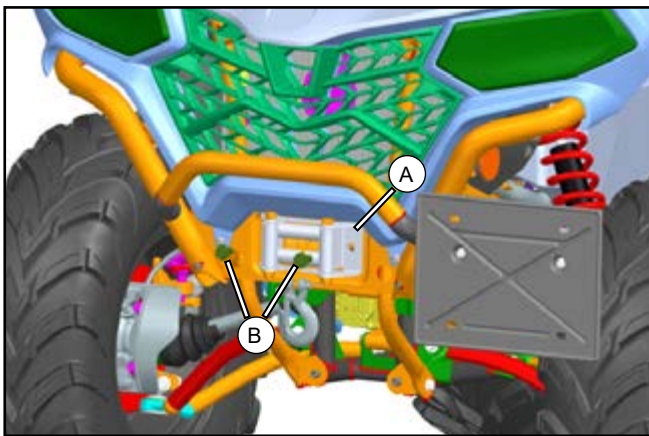

// Remove the bolts (B) from the winch fairlead (A).

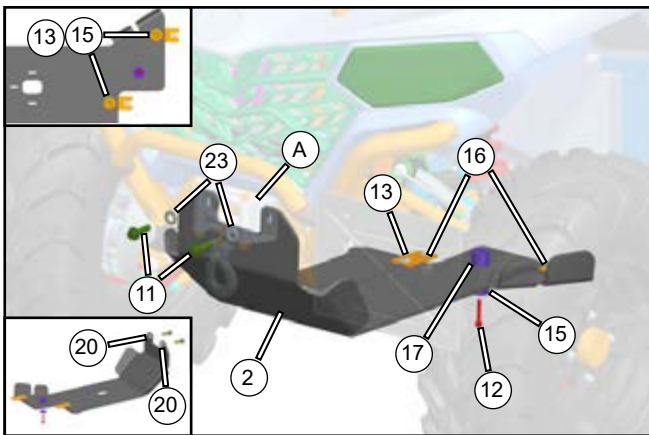

// Secure the connecting brackets (16) to front skid plate (2) with bolts (13) and retainers (15). See inset image.

// To assist with installation, apply adhesive or double-sided tape to spacers (20) and (17) and fix them to the front skid plate (2) at the locations shown.

// Finger-tighten the front skid plate (2) to the vehicle frame with bolts (12) and retainers (15).

// Finger-tighten the front skid plate (2) and winch fairlead with bolts (11) and washers (23).

i The identification of the front skid plate is F1.
The winch fairlead bolts will not be reused.

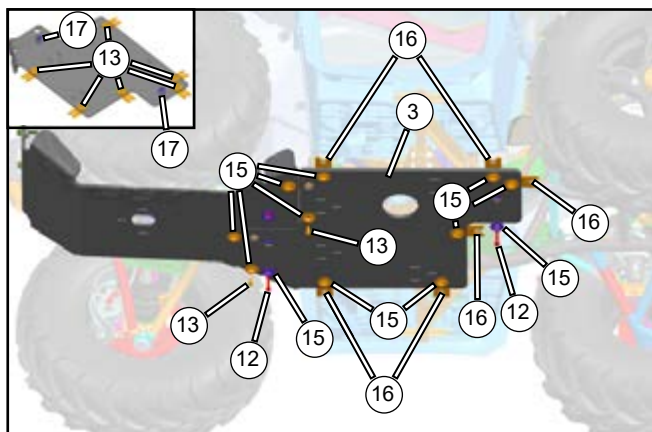
ASSEMBLY and INSTALLATION

- // Secure the connecting brackets (16) to the middle skid plate (3) with bolts (13) and retainers (15).
- // As shown in the inset image, secure spacers (17) to the middle skid plate (3) with double-sided tape or adhesive.
- // Finger-tighten the middle skid plate (3) to the the vehicle frame with bolts (12) and retainers (15) at the locations shown.
- // Finger-tighten the middle skid plate (3) to the connecting brackets (16) with bolts (13) and retainers (15).

i The identification of the middle skid plate is MS2.

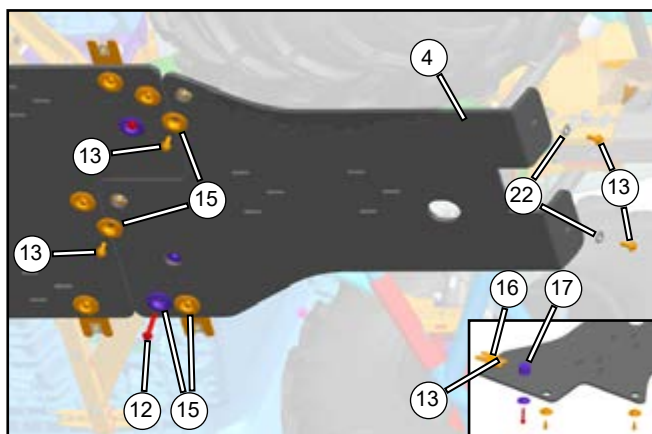

- // Secure the connecting brackets (16) to the rear skid plate (4) with bolts (13) and retainers (15).
- // As shown in the inset image, secure spacers (17) to the rear skid plate (4) with double-sided tape or adhesive.
- // Finger-tighten the rear skid plate (4) to the vehicle frame with bolts (12) and retainers (15) at the locations shown.
- // Secure the rear skid plate (4) to the frame with bolts (13) and washers (22). Then finger-tighten the bolts (13) and retainers (15) to connecting brackets (16).

i The identification of the rear skid plate is R3.

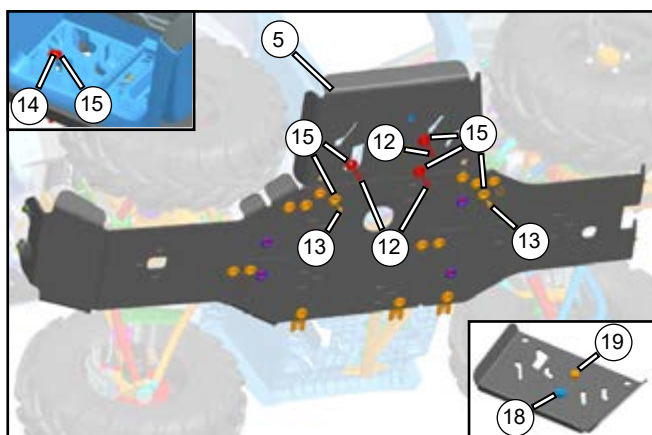

- // As shown in the inset image, secure spacers (18,19) to the left skid plate (5) with double-sided tape or adhesive.
- // Secure the left skid plate (5) to the left bottom of the vehicle with bolts (12) and retainers (15).
- // Then, install the bolt (12) and retainer (15) through the footrest and tighten with self-lock nut (14). See inset image.
- // Finger-tighten the bolts (13) and retainers (15) to connecting brackets (16).

i The identification of the left skid plate is L5S.

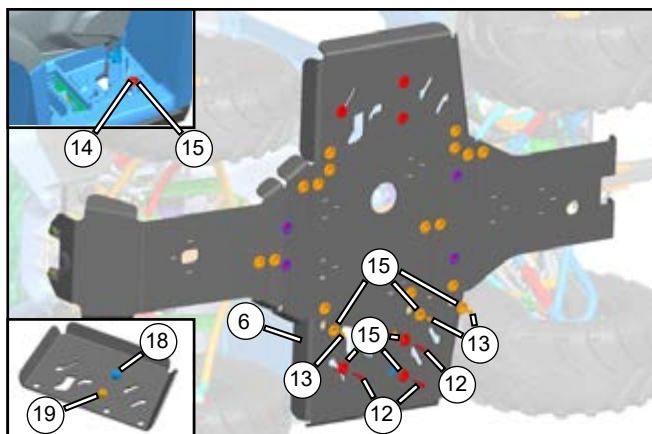

- // As shown in the inset image, secure spacers (18,19) to the right skid plate (6) with double-sided tape or adhesive.
- // Secure the right skid plate (6) to the right bottom of the vehicle with bolts (12) and retainers (15).
- // Then, install the bolt (12) and retainer (15) through the footrest and tighten with self-lock nut (14). See inset image.
- // Finger-tighten the bolts (13) and retainers (15) to connecting brackets (16).

i The identification of the right skid plate is R4S.

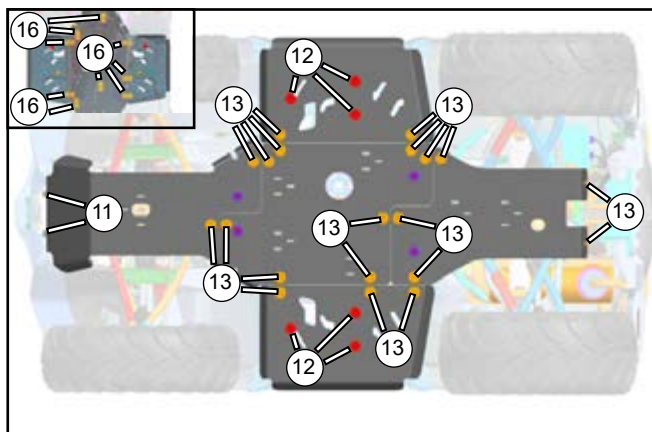
ASSEMBLY and INSTALLATION

- // Perform final torque of the skid plates as an assembly. First, tighten the bolts (13) installed in the connecting brackets (16).
- // Then, tighten the bolts (11), bolts (12) and bolts (13) in order.
- // Hand tighten all fasteners sufficiently, using caution not to over-tighten.

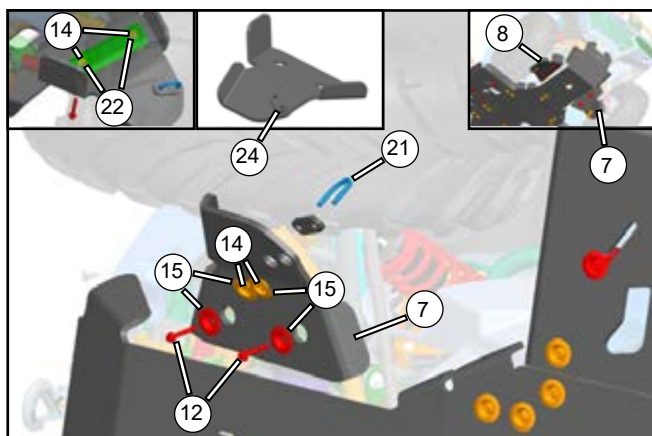

- // As shown in the image, secure the washer (24) to the front swing-arm panel (7-left shown) at the location shown with double-sided tape or adhesive.
- // Install the front swing-arm panel (7-left shown) to the front swing-arm with U-shape bolt (21), retainers (15) and self-locking nuts (14). *Do not fully tighten at this time.*
- // Install the bolts (12), retainers (15), washers (22) and self-locking nuts (14).
- // Tighten the self-locking nuts (14) and U-shape bolt (21).

i The identification of the panel (7) is F7L, and panel (8) is F6R. The right panel (8) is assembled in the same way.

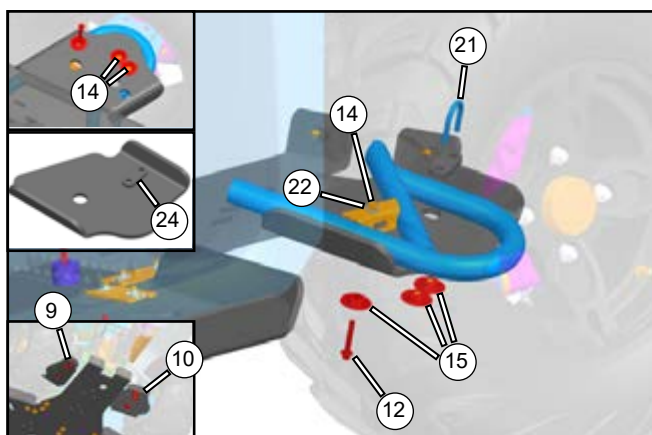

- // As shown in the image, secure the washer (24) to the rear swing-arm panel (9-left shown) at the location shown with double-sided tape or adhesive.
- // Install the left rear swing-arm panel (9-left shown) to the left rear swing-arm with U-shape bolt (21), retainers (15) and self-locking nuts (14). *Do not fully tighten at this time.*
- // Install the bolts (12), retainers (15), washers (22) and self-locking nuts (14).
- // Tighten the self-locking nuts (14) and U-shape bolt (21).

i The identification of the panel (9) is R9L, and panel (10) is R8R. The right panel (10) is assembled in the same way.

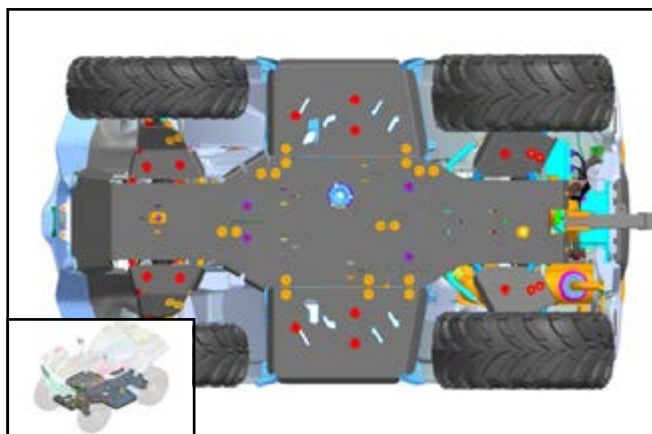

- // The skid plates are assembled. Re-verify all fasteners are secure.